



LAVASCIUGA 510-610-710/LB





TAVOLA 1 - LB



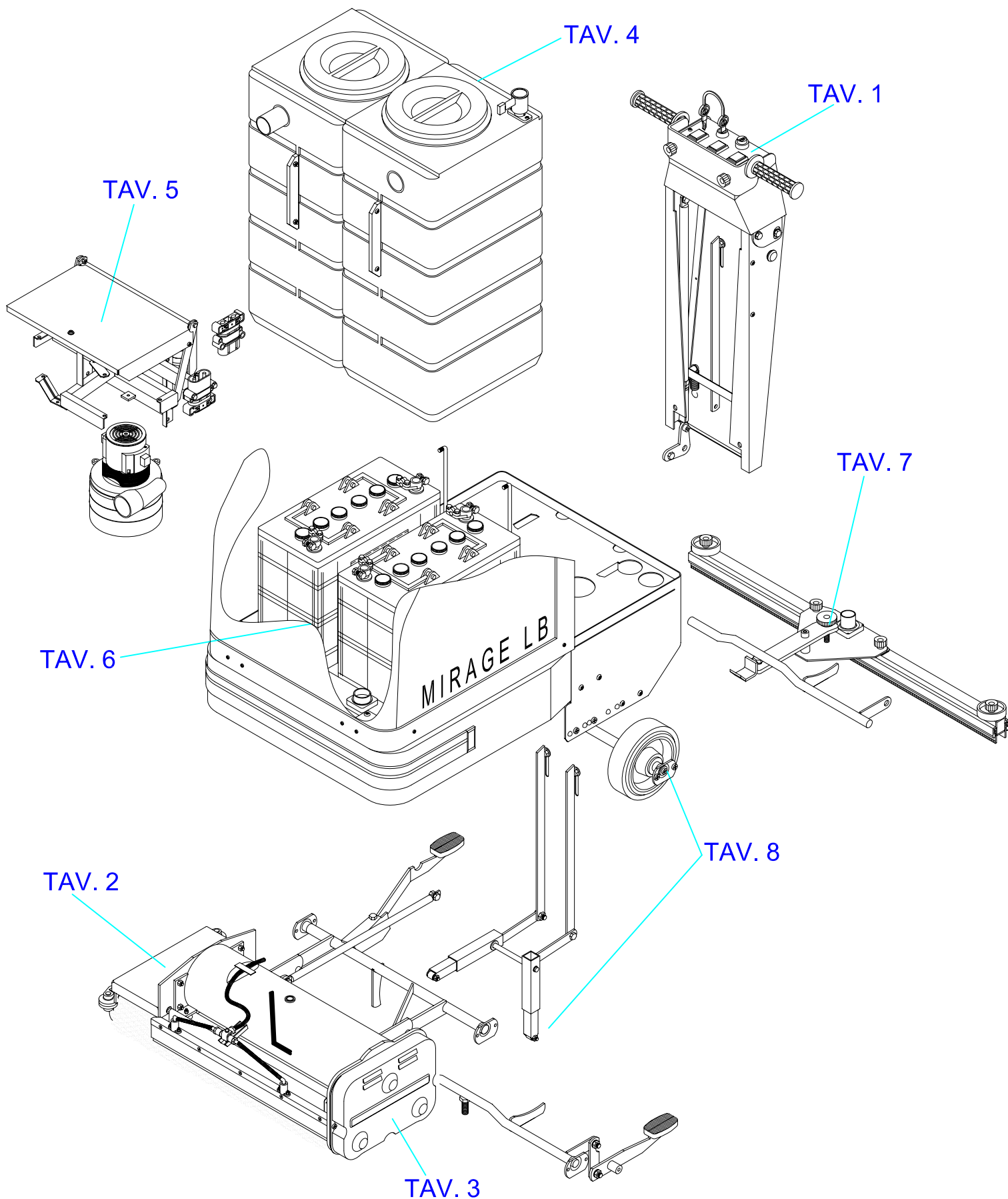

TAVOLA 2 - LB



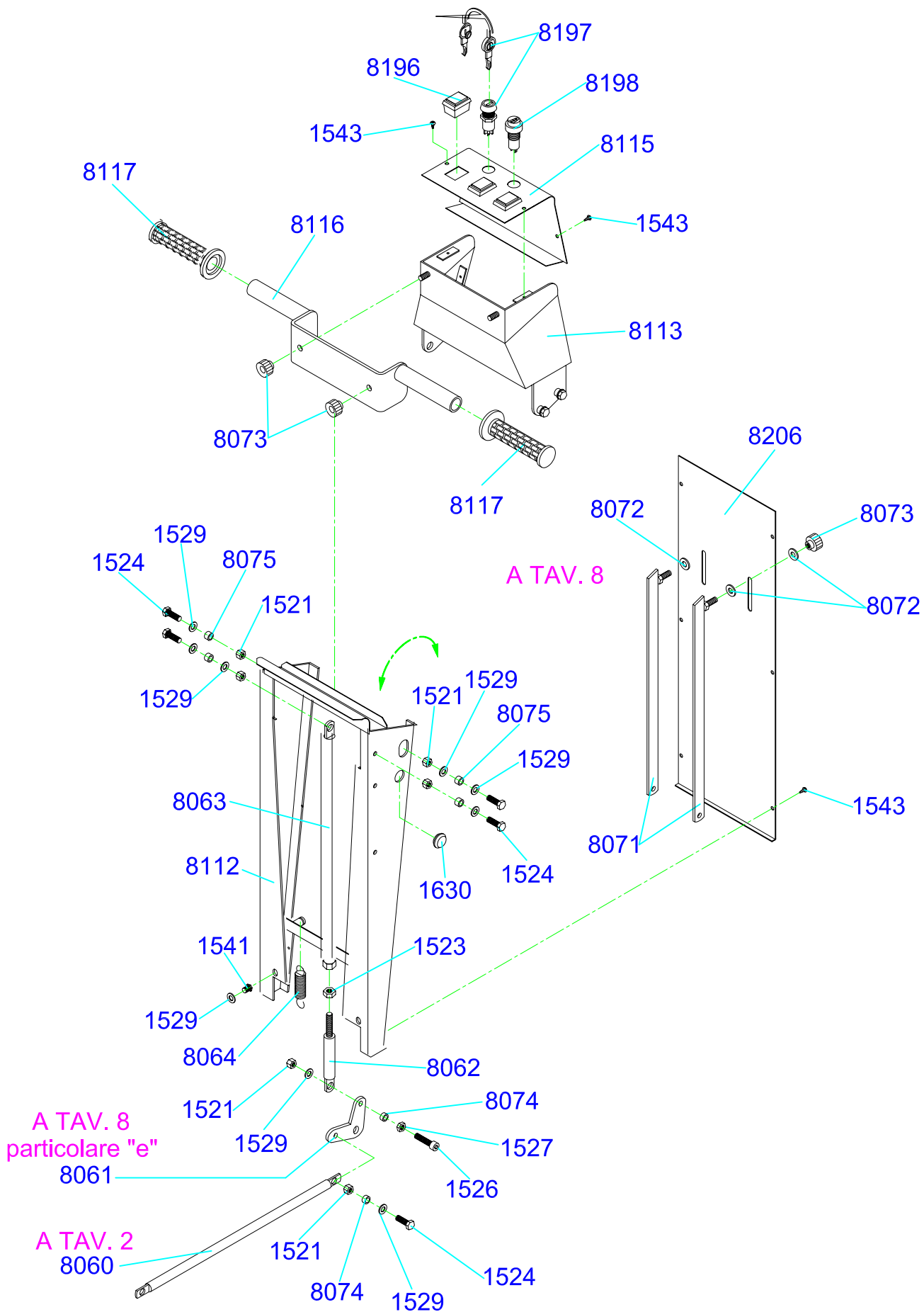

TAVOLA 3 - LB

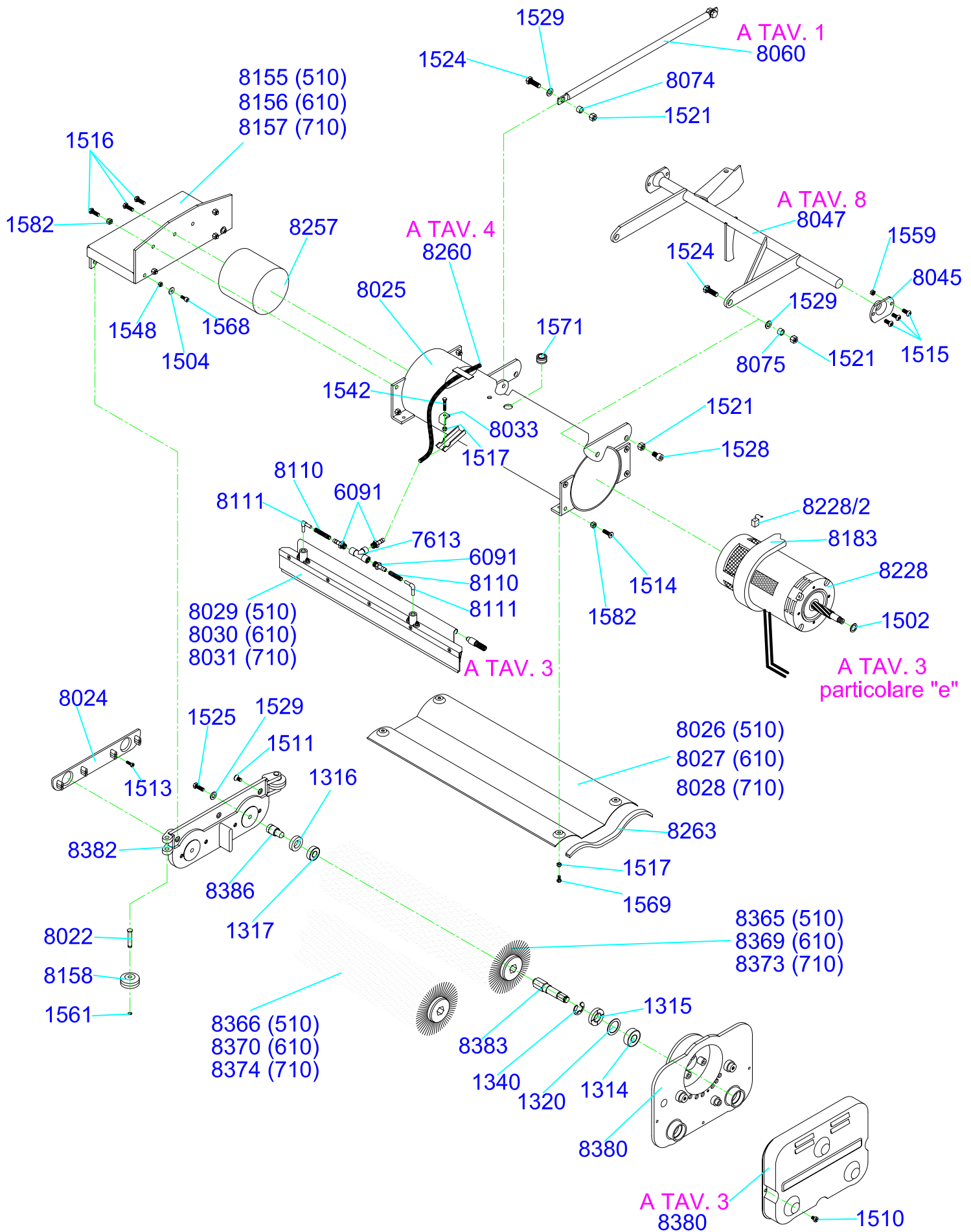
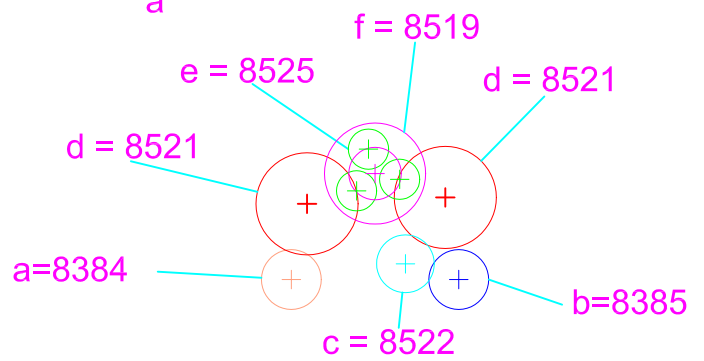
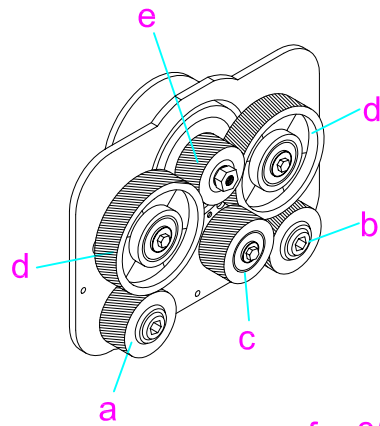
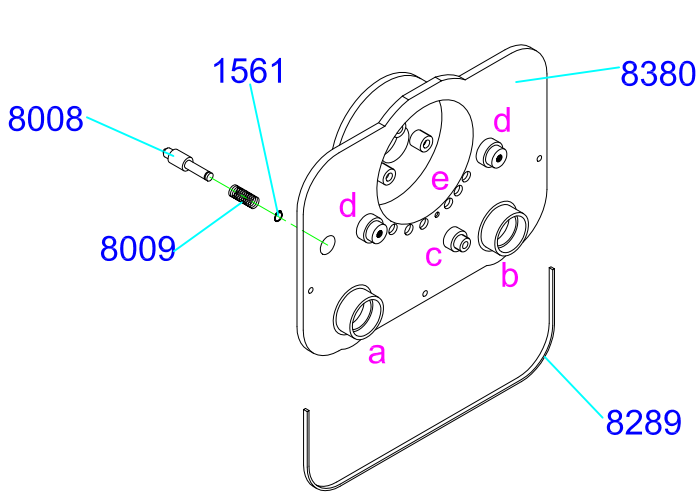

KIT

- 8519=8012+1564+1563
- 8521=8168+1560+1566
- 8522=8013+1507+1508
- 8525=8167+1562+1501
- a=8384
- b=8385

DISPOSIZIONE INGRANAGGI





TAVOLA 4 - LB



A TAV. 2
8260

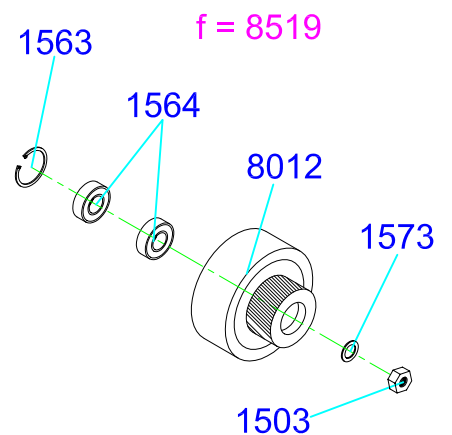
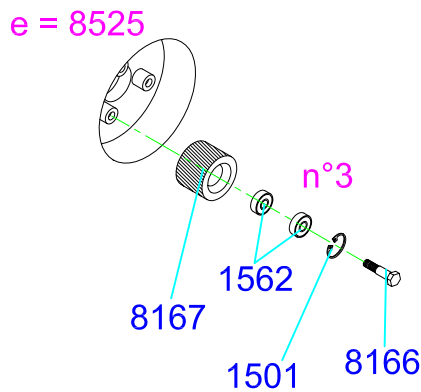
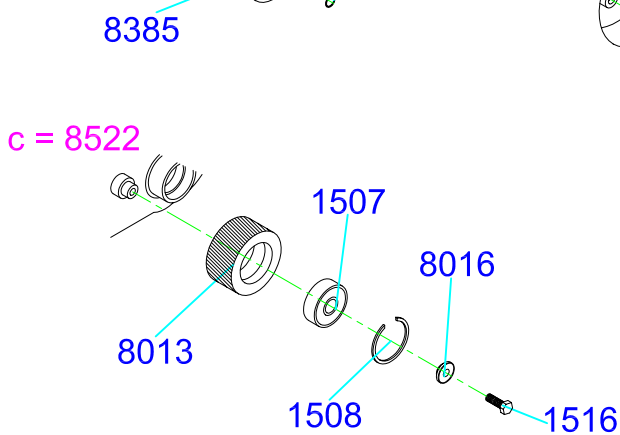
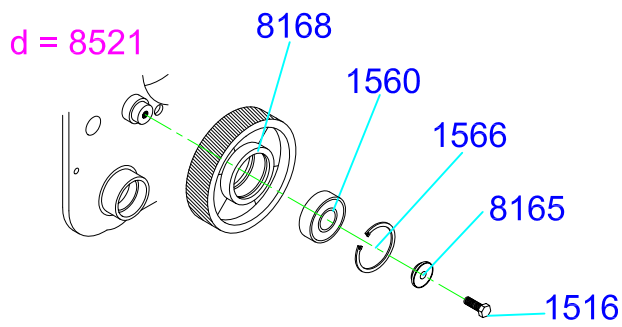
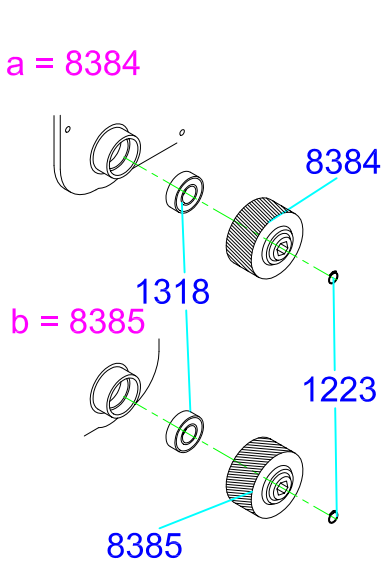
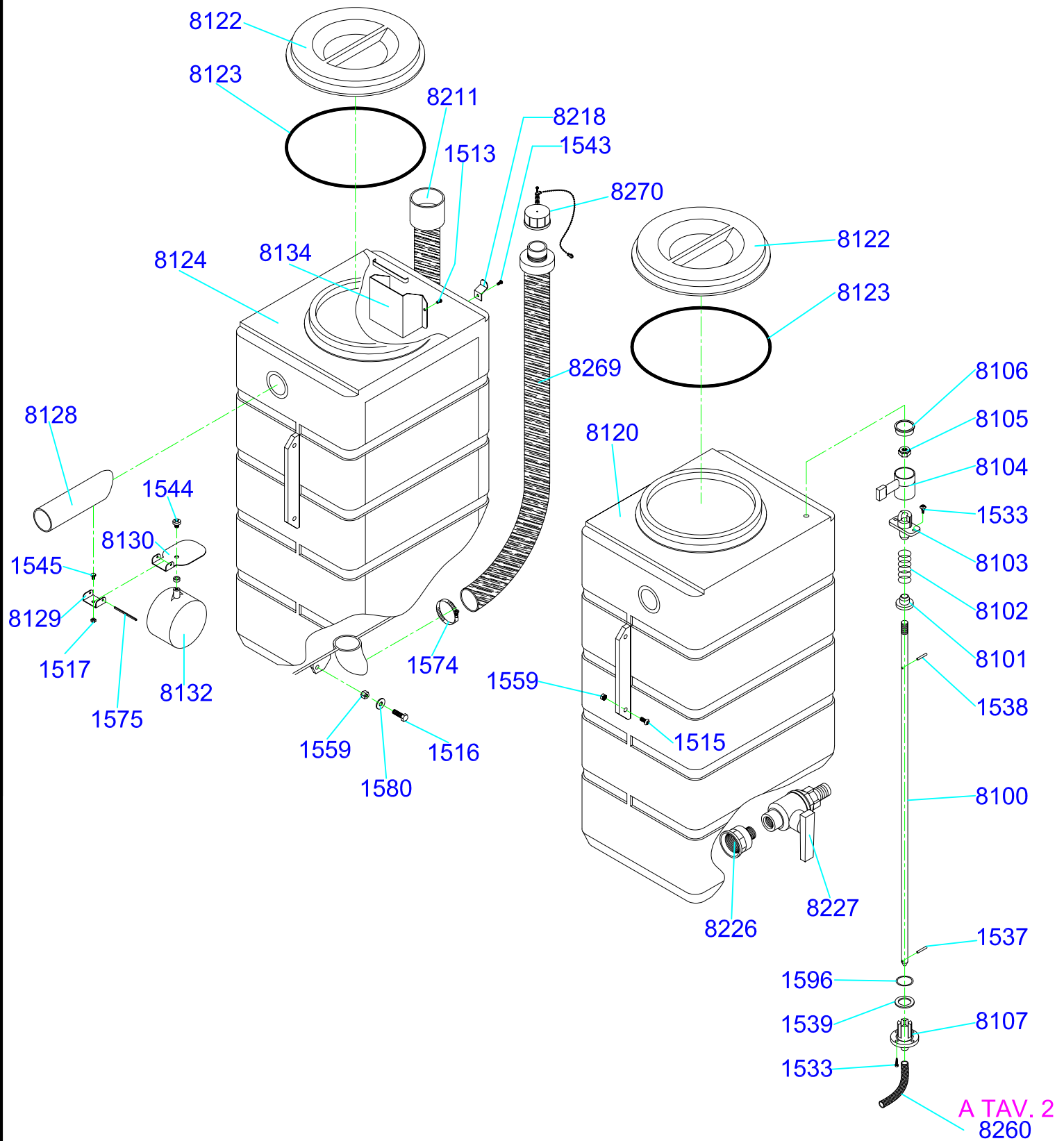

TAVOLA 5 - LB





TAVOLA 6 - LB



VERSIONE CON N°2 BATTERIE 12 V 120 Ah

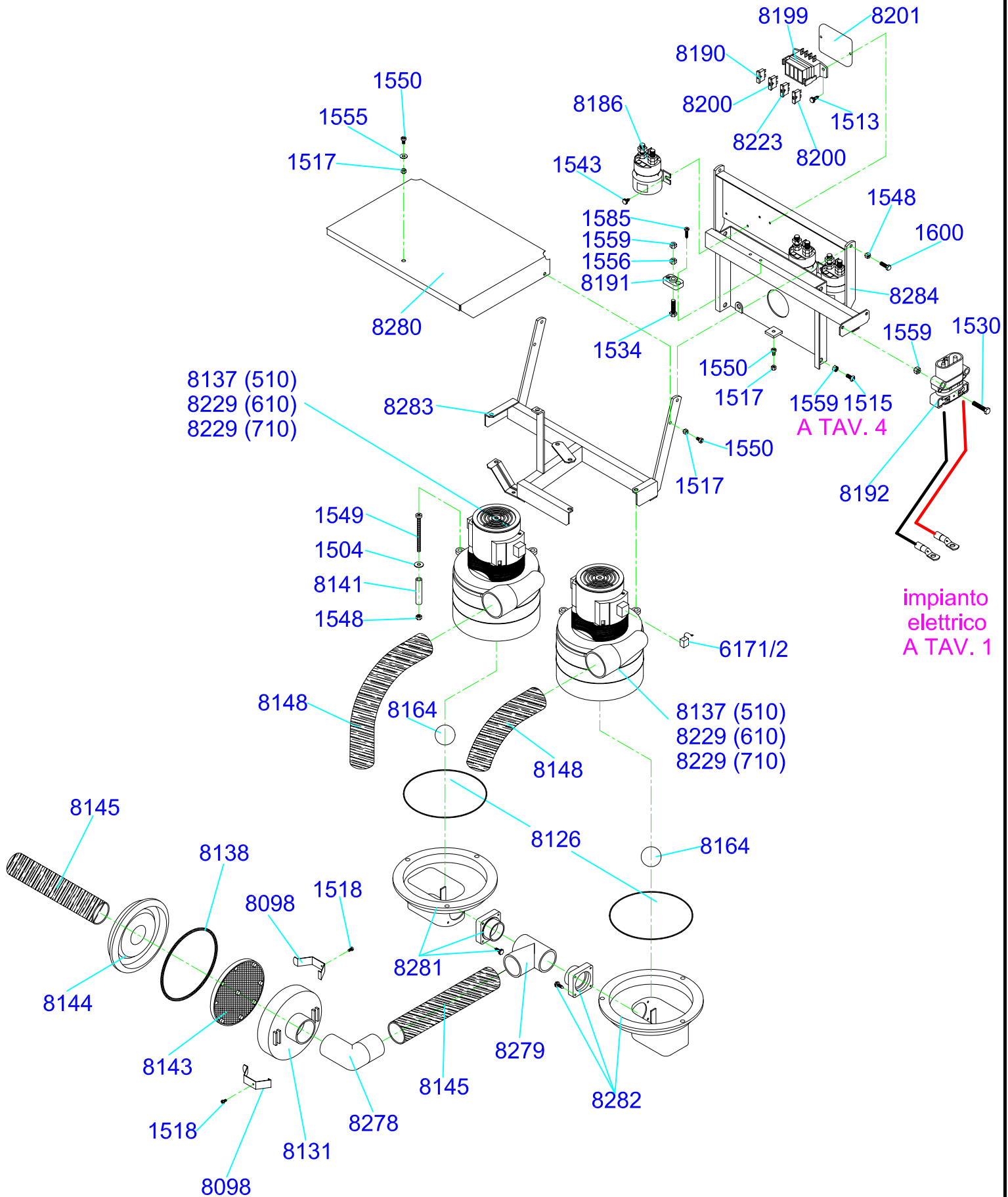
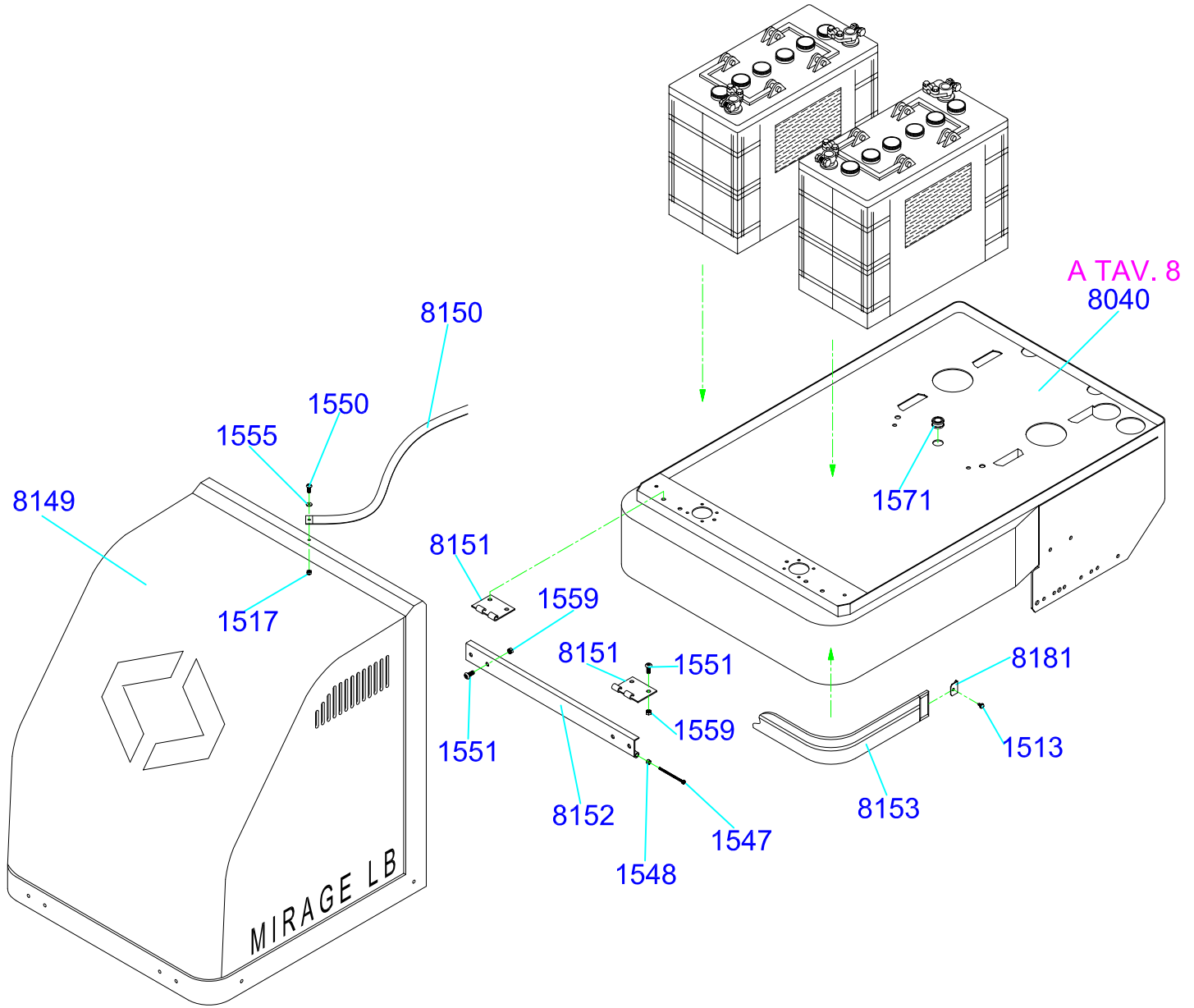
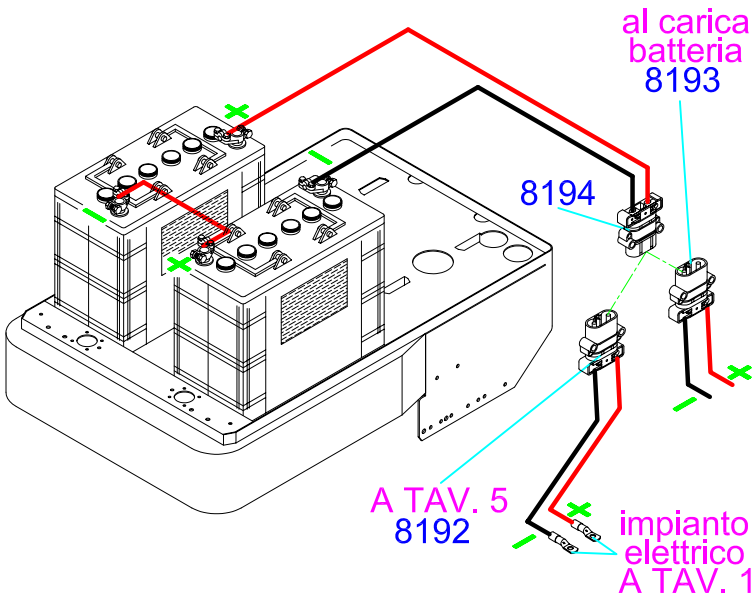

VERSIONE CON N°4 BATTERIE 6 V 240 Ah





TAVOLA 7 - LB



TERGIPAVIMENTO DIRITTO

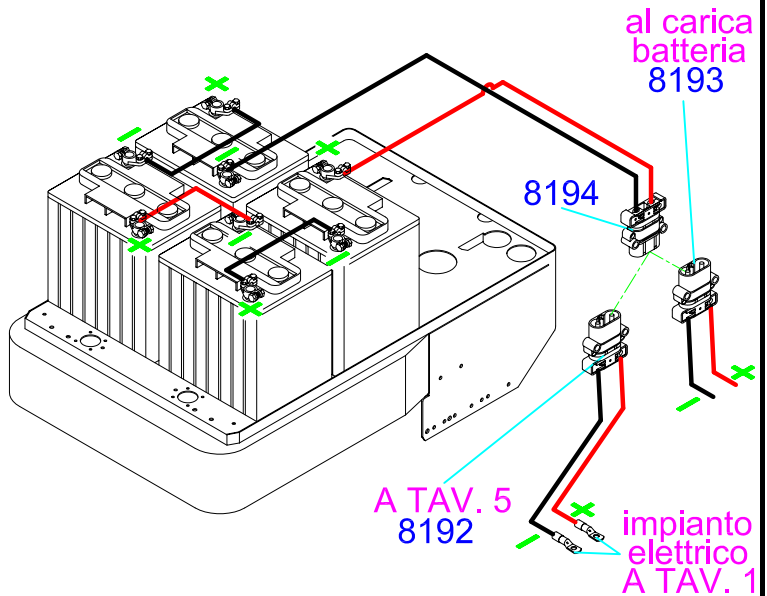
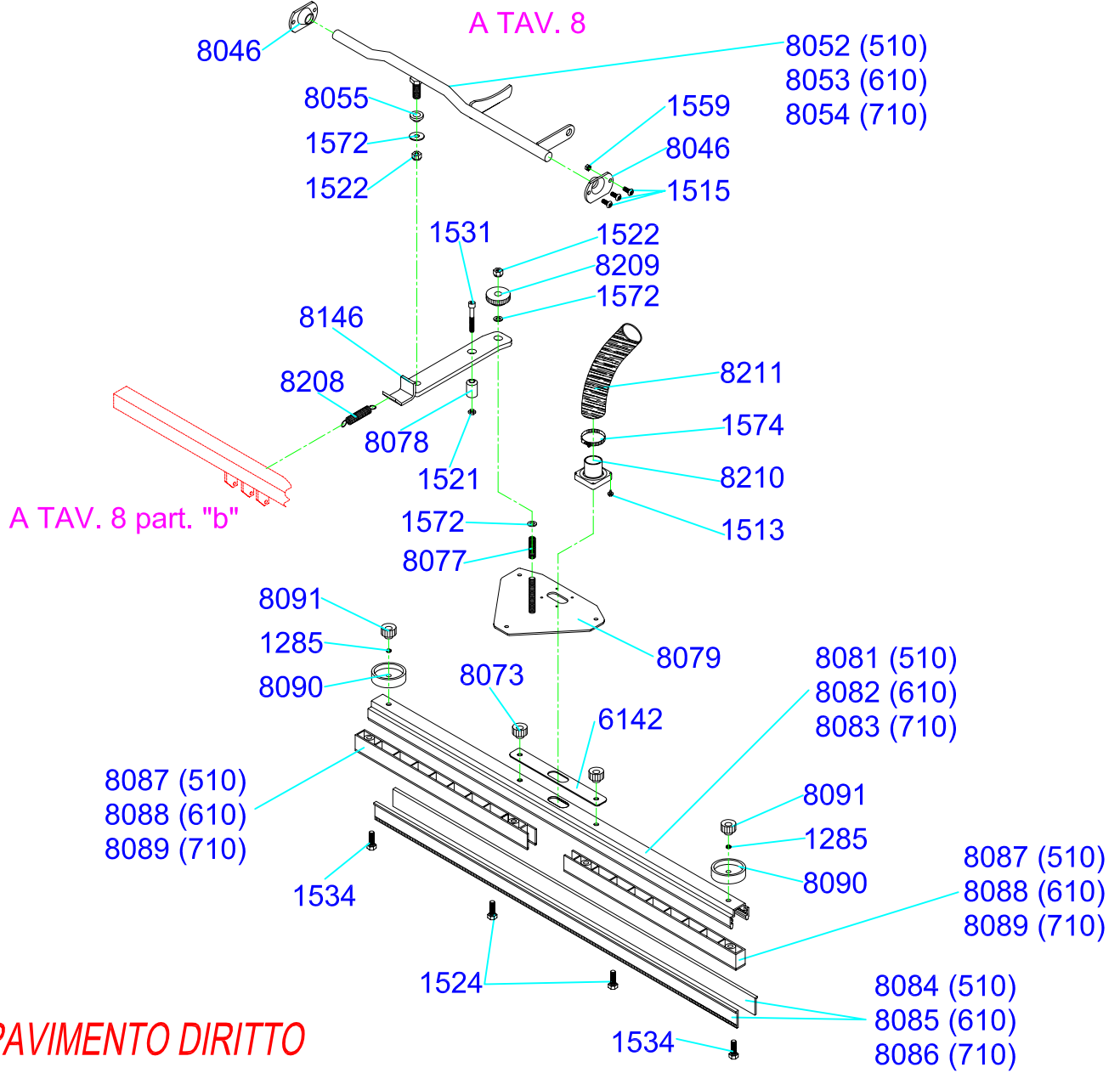
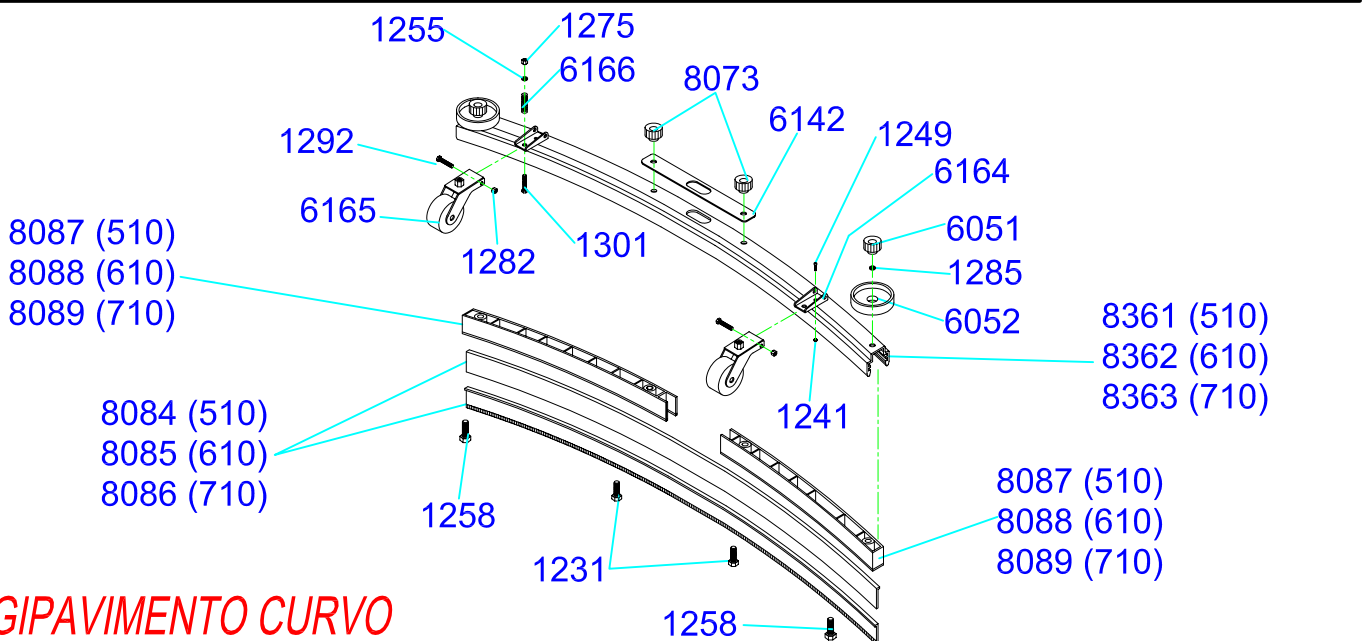

TERGIPAVIMENTO CURVO



TAVOLA 8 - LB

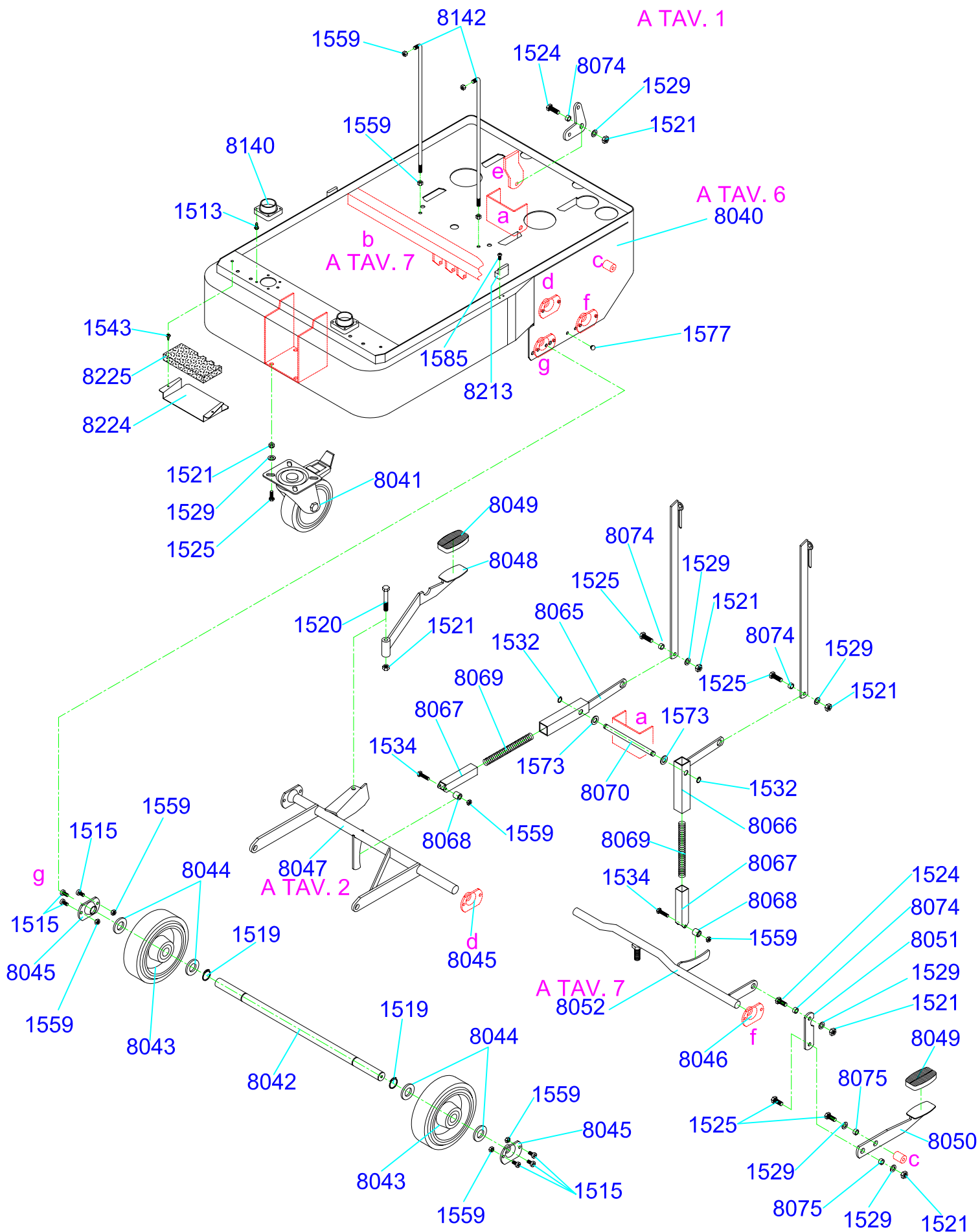



COD.	NOTE	Q. TA'	TAV. N°	DESCRIZIONE	DESCRIPTION
					



1223		2	3	SEEGER E. ø 12	EXTERNAL SEEGER ø 12
1231		2	7	VITE TE M.8 X 25 INOX	TE M.8 X 25 STAINLESS STEEL SCREW
1241		6	7	DADO BLOK M.4 BASSO ZNT	M.4 ZNT BLOCH NUT
1249		4	7	VITE TC CROCE M.4 X 14 INOX	TC M.4 X 12 STAINLESS STEEL CROSS SCREW
1255		2	7	RONDELLA PIANA ø 6 INOX	ø 6 STAINLESS STEEL FLAT WASHE
1258		2	7	VITE TE M.6 X 25 INOX	TE M.6 X 25 STAINLESS STEEL SCREW
1275		2	7	DADO BLOK M.6 BASSO ZNT	M.6 ZNT LOW BLOCH NUT
1282		2	7	DADO BLOK M.5	M.5 BLOCH NUT
1285		2	7	RONDELLA DENTELLATA M.6 - 6.4 ZNT	M.6 - 6.4 ZNT WASHER
1292		2	7	VITE TE INOX M.5 X 35	SCREW INOX M. 5 X 35 DIN 931
1301		2	7	VITE TT - QST M.6 X 25 ZNT	SCREW TT - QST M. 6 X 25 ZNT 5731
1316		2	2	ANELLO TENUTA RP ø 17 X 35 X 7 TC	RP ø 17 X 30 X 7 HELD RING
1317		2	2	CUSCINETTO 15 X 35 X 11 (6202 2RS)	12 X 28 X 8 (6001 2RS) BEARING
1318		2	3	CUSCINETTO 15 X 32 X 9 (6002 2RS)	15 X 32 X 9 (6002 2RS) BEARING
1320		2	2	SEEGER TIPO PS ø 25 X 35 SP 1	PS ø 25 X 35 SP 1 SEEGER TIP
1340		2	2	SEEGER E. ø 15 RS RADIALE	ø 15 RS RADIAL EXTERNAL SEEGER
1501		3	3	SEEGER I. ø 19 DIN 472	INTERNAL SEEGER ø 19
1502		2	2	RONDELLA ø 12 X 18 SP.1 DIN 988	ø 12 X 18 SP.1 WASHER
1503		1	3	DADO M.10 SINISTRO	M.10 LEFT NUT
1504		7	2,5	RONDELLA PIANA ø 5 X 16 INOX UNI 6593	ø 5 X 16 WASHER
1507		1	3	CUSCINETTO 6301 2RS	6301 2RS BEARING
1508		1	3	SEEGER I. SB ø 37	SB INTERNAL SEEGER ø 37
1510		3	2	VITE TC CROCE M.5 X 8 INOX	TC M.5 X 8 CROSS SCREW
1511		3	2	VITE VSP M.6 X 12 INOX	TPSEI M.6 X 12 STAINLESS STEEL SCREW
1513		9	2,4,5,6,7,8	VITE AUTOFILETTANTE T.E. 7976 F.R. 3.9 X 13 D.C.R.O	AUT. KF 3.9 X 13 INOX SCREW
1514		4	2	VITE VSP M.6 X 18 INOX DIN 7991-A	VSP M.6 X 18 SCREW
1515		22	2,4,5,7,8	VITE TC CROCE M.6 X 14 INOX DIN 7981	SCREW TC CROSS M. 6 X 14 INOX
1516		11	2,3,4	VITE TE M. 6 X 18 INOX	TE M.6 X 18 STAINLESS STEEL SCREW
1517		10	2,4,5,6	DADO BLOK M.4 ZNT DIN 985 BASSO	ZNT M.4 LOW BLOCH NUT
1518		2	5	VITE AUTOFILETTANTE TSC ø 3,9 X 13 ZNT	TSC 3.9 X 13 SELF - TAPPING SCREW
1519		2	8	SEEGER E. ø 20 DIN 471 ZNT	SEEGER E ø 20 DIN 471 ZNT
1520		2	8	VITE TE M.8 X 55 ZNT DIN 931	TE M.8 X 55 SCREW
1521		20	1,2,7,8	DADO BLOK M.8 BASSO ZNT 985	DICE BLOK M. 8 LOW ZNT 985
1522		1	7	DADO BLOK M.12 BASSO ZNT 985	DICE BLOK M. 12 LOW ZNT 985
1523		1	1	DADO M.10 ZNT DIN 934	M.10 NUT
1524		16	1,2,7,8	VITE TE M.8 X 25 INOX DIN 933	SCREW TE M. 8 X 25 INOX DIN 933
1525		7	2,8	VITE TE M.8 X 20 INOX DIN 933	TE M.8 X 20 STAINLESS STEEL SCREW
1526		1	1	VITE TCEI M.8 X 25 ZNT DIN 933	TCEI M.8 X 35 ZNT SCREW
1527		1	1	DADO M.8 ZNT DIN 934	ZNT M.8 NUT
1528		2	2	VITE TCEI M.8 X 14 INOX	TCEI M.8 X 14 SCREW
1529		21	1,2,8	RONDELLA PIANA ø 8 INOX	FLAT WASHER ø 8 X 16 INOX
1530		1	5	VITE TE M.6 X 30 ZNT	SCREW TE M. 6 X 30 ZNT
1531		1	7	VITE TCEI M.8 X 50 DIN 912 ZNT	TCEI M.8 X 50 SCREW
1532		2	8	SEEGER E. ø 10 DIN 471	EXTERNAL ø 10 SNAP RING
1533		6	4	VITE AUTOFILETTANTE KF ø 3,9 X 19 INOX DIN 7981	SCREW AUT. KF ø 3,9 X 19 INOX DIN
1534		6	5,7,8	VITE TE M.6 X 25 INOX DIN 933	SCREW TE M. 6 X 25 DIN 933 INOX
1537		1	4	SPINA ELASTICA SPIROL INOX ø 3 X 20	ELASTIC THORN ø 3 X 20 INOX
1538		1	4	SPINA ELASTICA ø 2,5 X 14 INOX	ELASTIC THORN ø 2,5 X 14 INOX
1539		1	4	ANELLO "OR" COD. 3087	RING "OR"
1541		2	1	VITE TE M.8 X 12 INOX DIN 933	TE M.8 X 12 SCREW
1542		1	2	VITE TE M.4 X 25 ZNT	TE M.4 X 25 SCREW
1543		12	1,4,5,8	VITE AUTOFILETTANTE T.E. 7976 F.R. 3.9 X 6,5 D.C.R.O	SELF-TAPPING SCREW TE 7976 F.R. 3.9 X 6.5
1544		1	4	VITE TC CROCE M.6 X 8 INOX	SCREW TC CROSS M. 6 X 8 INOX
1545		1	4	VITE TE M.4 X 6 INOX DIN 933	SCREW TE M. 4 X 6 INOX DIN 933
1547		2	6	VITE TC CROCE M.5 X 65 DIN 7985 ZNT	SCREW TC CROSS M. 5 X 65 DIN 7985 ZNT
1548		7	2,5,6	DADO BLOK M.5 DIN 985 ZNT	DICE BLOK M. 5 LOW DIN 985 ZNT
1549		6	5	VITE TC CROCE M.5 X 70 ZNT DIN 7985	TC M.5 X 70 ZNT CROSS SCREW
1549/1		6	5	VITE TC CROCE M.5 X 70 ZNT DIN 7985	TC M.5 X 70 ZNT CROSS SCREW
1550		2	5,6	VITE TC CROCE M.4 X 12 INOX DIN 7985	SCREW TC CROSS M. 4 X 14 INOX DIN 798
1551		10	6	VITE TC CROCE M.6 X 12 INOX	SCREW TC CROSS M. 6 X 12 INOX
1555		6	5,6	RONDELLA PIANA M.4 X 12 INOX UNI 6593	FLAT WASHER M. 4 X 12 INOX
1556		2	5	DADO M.6 ZNT DIN 934	M.6 LB NUT
1559		35	2,4,5,6,7,8	DADO BLOK M.6 BASSO DIN 985 ZNT	DICE BLOK M. 6 LOW DIN 985 ZNT
1560		2	3	CUSCINETTO 6203 2RS	6203 2RS BEARING
1561		3	2,3	SEEGER E. ø 7 DIN 471	EXTERNAL ø 7 SNAP RING
1562		6	3	CUSCINETTO 607	607 BEARING
1563		1	3	SEEGER I. ø 32 DIN 472	INTERNAL SEEGER ø 32
1564		2	3	CUSCINETTO 6201 2RS	6201 2RS BEARING
1566		2	3	SEEGER I. ø 40 DIN 472	INTERNAL SEEGER ø 40
1568		1	2	VITE TCEI M.5 X 12 ZNT DIN 912	TCEI M.5 X 12 SCREW
1569		4	2	VITE TE M.4 X 10 INOX DIN 933	TE M.4 X 10 STAINLESS STEEL SCREW
1570		4	2	VITE TCEI M.6 X 12 ZNT	TCEI M.6 X 12 LB SCREW
1571		2	2,6	PASSACAVO NERO COD. 2080 15 X 18 GOLA 3,5	15 X 18 BLACK CHOCK COD. 2080
1572		2	7	RONDELLA OTTONE ø 12 SP. 2,5	WASHER BRASS ø 12 SP. 2,5
1573		3	3,8	RONDELLA PIANA ø 10 INOX	ø 10 STAINLESS STEEL FLAT WASHER
1574		2	4,7	FASCETTA A VITE 25 - 45 ZNT	JUBILEE CLIP 25 - 40 ZNT
1575		2	4	COPPIGLIA ø 2 X 10 INOX	SAFETY PIN ø 2 X 40 INOX
1577		4	8	TAPPINO ART. 07942 COLORE NERO	RUBBER STOPPER
1580		4	4	RONDELLA PIANA ø 6 X 18 INOX	FLAT WASHER ø 6 X 18 INOX
1582		8	2	DADO BLOK M.6 ALTO ZNT DIN 982	M.6 SELF - LOCKING NUT
1585		4	5,8	VITE AUTOFILETTANTE KF ø 3,9 X 16 ZNT	KF 3.9 X 16 SCREW
1596		1	4	ANELLO "OR" ø 1.7.59 X 2,62 EPDM	RING "OR" ø INT. 7.59 X 2.62
1600		2	5	VITE TE M.5 X 16 INOX	TE M.5 X 16 STAINLESS STEEL SCREW
1630		1	1	PASSACAVO PVC FORO CHIUSURA MEMBRANA 16 - 2 - 21 - 25	CHOCK PVC HOLE CLOSING MEMBRANE 16 - 2 - 21 - 25
6051		2	7	VOLANTINO ø 30 M.6 MOD.1052/F	ø 30 M.6 HANDWHEEL



COD.	NOTE	Q. TA'	TAV. N°	DESCRIZIONE	DESCRIPTION
					

6052		2	7	RUOTA RIPARO ø 70	ø 70 SAFETY GUARD WHEEL
6091		2	2	PORTAGOMMA 1/8 ø 9	1/8 ø 9 HOSE HOLDER
6142		1	7	GOMMA ADESIVA TERGI SP.2	ADHESIVE FLOOR WIPER RUBBER
6164		2	7	STAFFA TERGI CURVO FORESI	CURVED STIRRUP WIPER
6165		2	7	SUPPORTO RUOTA TERGI CURVO COMPLETO	SUPPORT AND COMPLETE CURVED WHEEL WIPER
6166		2	7	MOLLA PR. F.1 ø E. 10.5 LL 16 SP.4 INOX	SPRING PR. F.1 ø E. 10.5 LL 16 SP.4
6171/2		2	5	SPAZZOLA CARBONE V24 ASPIRATORE	V24 BRUSH COAL EXHAUST FAN
7613		1	2	PORTAGOMMA 3 VIE OTTONE	T - F 1/8 V
8008		1	3	PERNO GOCCIOLATOIO	DRIP PIN
8009		1	3	MOLLA GOCCIOLATOIO PR. F. 1,2 - 10,4 LL 23 - SP. 6 TD INOX	DRIP SPRING
8012		1	3	INGRANAGGIO CAMPANA LB - LC	LC BELL GEAR
8013		1	3	INGRANAGGIO DENTATO DX	RIGHT - HAND SERRATED GEAR
8016		1	3	RONDELLA ø 6 X 18 ZNT	ZNT ø 6 X 15 WASHER
8019		1	2	CARTER FIANCATA	SIDE CASE
8022		2	2	PERNO RUOTA ZNT	WHEEL PIN
8024		1	2	PROFILO RIPARO	GUARD PROFILE
8025		1	2	TUBO SUPPORTO MOTORE ø 139 X 472	MOTOR SUPPORT PIPE
8026	510	1	2	CARTER SPAZZOLA L. 510 INOX	510 BRUSH CASE
8027	610	1	2	CARTER SPAZZOLA L. 610 INOX	610 BRUSH CASE
8028	710	1	2	CARTER SPAZZOLA L. 710 INOX	710 BRUSH CASE
8029	510	1	2	GOCCIOLATOIO COMPLETO L. 510	510 DRIP
8030	610	1	2	GOCCIOLATOIO COMPLETO L. 610	610 DRIP
8031	710	1	2	GOCCIOLATOIO COMPLETO L. 710	710 DRIP
8033		1	2	SQUADRETTA FISSAGGIO RACCORDO 3 VIE	SQUARE
8040		1	6,8	BASE LAVASCIUGA	FRAME
8041		1	8	SE. NG SUPPORTO GIREVOLE FRENO PEDALE RUOTA	ø 125 REVOLVING WHEEL
8042		1	8	ALBERO RUOTA ø 20 CROMATO	WHEEL SHAFT
8043		2	8	SE. NG RUOTA ø 160 X 45 F. 20	ø 160 WHEEL
8044		4	8	RONDELLA DI SPESSORAMENTO ø 20	SHIMMING WASHER
8045		4	2,8	SUPPORTO ALBERO ø 20	ø 20 SHAFT SUPPORT
8046		2	7,8	SUPPORTO ALBERO ø 17 LB	ø 17 LB SHAFT SUPPORT
8047		1	2,8	ALBERO SOLLEVAMENTO SPAZZOLE	BRUSH LIFT SHAFT
8048		1	8	LEVA PEDALE SPAZZOLE	BRUSH PEDAL LEVER
8049		2	8	COPRI PEDALE GOMMA ART. 61 COLORE NERO	PEDAL RUBBER
8050		1	8	LEVA PEDALE TERGI	WIPER PEDAL LEVER
8051		1	8	COLLEGAMENTO PEDALE TERGI	WIPER CONNECTION PEDAL
8052	510	1	7,8	ALBERO SOLLEVAMENTO TERGI LB. 510	510 LB WIPER LIFT SHAFT
8053	610	1	7	ALBERO SOLLEVAMENTO TERGI LB. 610	610 LB WIPER LIFT SHAFT
8054	710	1	7	ALBERO SOLLEVAMENTO TERGI LB. 710	710 LB WIPER LIFT SHAFT
8055		1	7	BRONZINA ø 22 OTTONE	BUSHING
8060		1	1,2	LEVA ø 14 COLLEGAMENTO MOTORE	ø 14 MOTOR CONNCTION
8061		1	1	PIATTO GIREVOLE	REVOLVING PLATE
8062		1	1	LEVA ø 14 CORTA	SHORT ø 14 CONNECTION
8063		1	1	LEVA ø 16 COLLEGAMENTO MANICO	HANDLE ø 16 CONNECTION
8064		1	1	MOLLA TR. F. 2,5 - 20 CM. 60 G.I. ZNT	ø 20 TRACTION SPRING
8065		1	8	REGOLAZIONE PESO MOTORE	MOTOR WEIGHT ADJUSTMENT
8066		1	8	REGOLAZIONE PESO TERGI	WIPER WEIGHT ADJUSTMENT
8067		2	8	PORTA MOLLA PESO - REGOLAZIONE	SPRING HOLDER WEIGHT / ADJUSTMEN
8068		2	8	RULLINO REGOLAZIONE	ADJUSTMENT PIN
8069		2	8	MOLLA REGOLAZIONE PESE F. 2 - 15 - 140 - 31 TDM ZNT	WEIGHT ADJUSTMENT SPRING
8070		1	8	PERNO REGOLAZIONE PESI ø 10 INOX	WEIGHT ADJUSTMENT PIN
8071		2	1	COLLEGAMENTO REGOLAZIONE PESI	WEIGHT ADJUSTMENT CONNCTION
8072		4	1	RONDELLA PLASTICA ø 8	ø 8 PLASTIC WASHER
8073		6	1,7	VOLANTINO TERMOP. MOD. 1052 / F ø 40 M.8	M.8 ø 40 HANDWHEEL
8074		8	1,2,8	ANELLO DISTANZIALE L. 5,8	L. 5.8 DISTANCE RING
8075		7	1,2,8	ANELLO DISTANZIALE L. 7,5	L. 7.5 DISTANCE RING
8077		1	7	MOLLA TERGI PR F. 2,5 - 18 - 55 - 7,5 TDM INOX	ø 17 WIPER SPRING
8078		1	7	DISTANZIALE SNODO ZNT	ARTICULATED JOINT SPACER
8079		1	7	PIASTRA SUPPORTO TERGI	WIPER SUPPORT PLATE
8081	510	1	7	PROFILO TERGI L. 510	510 WIPER PROFILE
8082	610	1	7	PROFILO TERGI L. 610	610 WIPER PROFILE
8083	710	1	7	PROFILO TERGI L. 710	710 WIPER PROFILE
8084		2	7	GOMMA TERGI SH. 22 - 25	510 WIPER RUBBER
8085		2	7	GOMMA TERGI SH. 22 - 25	610 WIPER RUBBER
8086		2	7	GOMMA TERGI SHR 22 - 25 MORBIDA 8084 - 85	WIPER RUBBER
8087	510	2	7	DISTANZIALE INTERNO TERGI L. 510	510 INTERNAL WIPER SPACER
8088	610	2	7	DISTANZIALE INTERNO TERGI L. 610	610 INTERNAL WIPER SPACER
8089	710	2	7	DISTANZIALE INTERNO TERGI L. 710	INTERNAL WIPER SPACER
8090		2	7	RUOTA LATO TERGI 2550 - 2550/1	WIPER END WHEEL
8091		2	7	VOLANTINO TERMOP. MOD. 1052 / F ø 30 M.6	M.6 ø 30 HANDWHEEL
8098		2	5	MOLLA SCATOLA FILTRO	FILTER SPRING
8100		1	4	VALVOLA DETERGENTE ASTA INOX ø 9 X 655 FIL. M.10 X 20 1 LATO	VALVE FOR CHEMICALS
8101		1	4	SUPPORTO MOLLA	SPRING SUPPORT
8102		1	4	MOLLA VALVOLA PR F. 1,5 - 20 - 50 - 7 TD AISI	ø 17 STAINLESS STEEL SPRING
8103		1	4	SUPPORTO POMELLO	KNOB SUPPORT
8104		1	4	POMELLO COMANDO VALVOLA	VALVE CONTROL KNOB
8105		1	4	DADO BLOK M.10 DIN 985 INOX	M.10 SELF - LOCKING NUT
8106		1	4	TAPPO DI CHIUSURA	STOPPER
8107		1	4	CORPO VALVOLA	VALVE BODY
8110		2	2	TUBICINO DETERGENTE ø 8	DETERGENT TUBE
8111		4	2	CURVA TUBICINO WS8	TUBE UNION
8112		1	1	SUPPORTO POSTERIORE COMPLETO LB	LB COMPLETE REAR SUPPORT
8113		1	1	SUPPORTO COMANDI	CONTROL SUPPORT
8115		1	1	QUADRO COMANDI BATTERIA LB	LB CONTROL BOARD
8116		1	1	MANUBRIO LC - LB	HANDLEBAR



COD.	NOTE	Q. TA'	TAV. N°	DESCRIZIONE	DESCRIPTION
					
8117		2	1	MANOPOLA ART. 01609V COLORE NERO	RUBBER HAND GRIP
8120		1	4	SERBATOIO SX AP GIALLO CON 1 BOC.	LEFT - HAND CLEAN WATER TANK
8122		2	4	COPERCHIO SERBATOIO	TANK COVER
8123		2	4	GUARNIZIONE COPERCHIO - SERBATOIO	COVER GASKET
8124		1	4	SERBATOIO DX AS GIALLO CON 3 BOC.	RIGHT - HAND DIRTY WATER TANK
8126		2	5	ANELLOTENUTA GOMMA CONVOGLIATORE	GROMMET
8128		1	4	TUBO INOX ø 40 PER GALEGGIANTE	FLOATING STAINLESS STEEL PIPE
8129		1	4	STAFFA PER FARFALLA GALEGGIANTE	THROTTLE BRACKET FOR FLOAT
8130		1	4	FARFALLA GALEGGIANTE	FLOATING THROTTLE
8131		1	5	SCATOLA FILTRO	FILTER BOX
8132		1	4	GALEGGIANTE PIATTO CON INSERTO	FLOAT
8134		2	4	DEFLETTORE ARIA	AIR BAFFLE
8137		2	5	MOTORE R36ATSS 24V CC 480W + AN CAV.	24 V LB ASPIRATOR
8138		1	5	ANELLO TENUTA GOMMA ø 6 L. 360	FILTER GOMMET
8140		2	8	RACCORDO A CONVOGLIATORE	CONVEYOR UNION
8141		6	5	DISTANZIALE ASPIRATORI ALLUMINIO ø10	ASPIRATOR SPACER
8142		2	8	TIRANTE ASPIRATORI - BASE M.6 X 348	M.6 X 345 TIE ROAD
8143		1	5	FILTRO	FILTER
8144		1	5	SCATOLA FILTRO ENTRATA	FILTER COVER
8145		1	5	TUBO FLESSIBILE ø 38 NERO	ø 38 FLEXIBLE PIPE
8146		1	7	TIMONE COLLEGAMENTO TERGI LB	LB WIPER CONNECTION
8148		2	5	TUBO FLESSIBILE ø 38 NERO	ø 38 FLEXIBLE PIPE
8149		1	6	COFANO COLORE GIALLO GOFF. MP 1400 SP. 8	FRONT CASE
8150		1	6	CORDA APERTURA COFANO	CASE OPENING CORD LC
8151		2	6	CERNIERA A TELAIO	FRAME HINGE
8152		1	6	CERNIERA DOPPIA A COFANO	DOUBLE CASE HINGE
8153		1	6	PR. ART.880 NERO DOP. SMUS. 45	BUMPER BANDP
8155	510	1	2	FIANCO SPORGENTE DX L. 510	510 PROJECTING RIGHT SIDE
8156	610	1	2	FIANCO SPORGENTE DX L. 610	610 PROJECTING RIGHT SIDE
8157	710	1	2	FIANCO SPORGENTE DX L. 710	710 PROJECTING RIGHT SIDE
8158		2	2	RUOTA PROTEZIONE ø 38 NERA	ø 38 PROTECTION WHEEL
8164		2	5	SFERA TUTTA GOMMA ø 39 RETTIFICA	SUCTION VALVE
8165		2	3	RONDELLA PER INGRANAGGIO	WASHER FOR GEAR
8166		3	3	PERNO ESAGONALE CH. 10	CH. 10 HEXAGONAL PIN
8167		3	3	INGRANAGGIO INTERNO CAMPANA DENTATO	LEFT - HAND HELIC. GEAR
8168		2	3	RUOTA ø 99 SX	ø 99 LEFT - HAND GEAR
8181		2	6	TERMINALE PARAU RTI INOX 8 / 10	BUMPER TERMINAL
8183		1	2	GOMMA MOUSSE ADESIVO 20 X 10	RUBBER STOPPER
8186		3	5	CONT. T - 106 1 NA BOB. INT. 80% V. 24	LB REMOTE CONTROL SWITCH
8190		1	5	FUSIBILE UNIVALE 5 A	5 A. LB STRIP FUSE
8191		1	5	DERIVAZIONE ISOLANTE LB	INSULATOR FOR LB
8192		1	5,6	SPINA COMPLETA 80 A LB	80 A. LB COMPLETE PLUG
8193		1	6	SPINA 80 A (EUROPA SBC80 16 25 MMQ)	80 A BATTERY CHARGER PLUG
8194		1	6	PRESA CON MORSETTI 80 A LB	80 A TAP WITH LB TERMINALS
8195		3	6	PONTE CON MORSETTI	BRIDGE WITH LB TERMINALS
8196		3	1	INTERRUTTORE BIPOLARE LUMINOSO TV / CN / G 24V	LB DOUBLE - POLE SWITCH
8197		1	1	INTERRUTTORE A CHIAVE 0-1 ESTRAZIONE	LB KEY SWITCH
8198		1	1	SEGNALATORE DI BATTERIA LBF	B BATTERY CHECK
8199		1	5	PORTAFUSIBILE 4 VIE USC.LATERALI	4 - WAY FUSE CARRIER
8200		2	5	VALV.FUS.A LAMA 30 A	30 A STRIP FUSE
8201		2	5	ISOLANTE LB	LB INSULATING SHEET
8206		1	1	COPERCHIO POSTERIORE	REAR COVER
8208		1	7	MOLLA TR F. 2,5 - 19 - CM. 90 - LEO. 124	WIPER CENTERING SPRING
8209		1	7	POMOLO BAKELITE M.12	WIPER ADJUSTMENT KNOB
8210		2	7	RACCORDO ø 35 TERGI	ø 35 WIPER UNION
8211		1	4,7	TUBO FLESSIBILE ø 35 A TERGI	FLEXIBLE WIPER PIPE
8213		2	8	GUIDA PER COFANO	CASE GUIDE SQUARE
8218		1	4	SUPPORTO TUBO DI SCARICO	OUTLET PIPE SUPPORT
8219		1	4	CATENELLA PER TAPPO SCARICO A.S.	CHAIN
8220		2	4	GANCIO PER CATENELLA ø 4	CHAIN HOOK
8223		2	5	ANELLO INTERNO CUSCINETTO IR 25 X 30 X 17	BEARING INTERNAL RING
8224		2	8	SUPPORTO SILENZIATORE	SILENCER
8225		2	8	FILTRO PER SILENZIATORE	FELT FOR SILENCER
8226		1	4	RIDUZIONE M - F 1 / 2" - 1"	TAP EXTENTION CLEAN WATER TANK
8227		1	4	VALVOLA SFERA ENOL. 1 / 2" F. C / PTG. ø 20	TAP FOR CLEAN WATER TANK
8228		1	2	MOTORE CC MP80M V24 G3000 W500 B14	MOTOR CC MP80M V24 G3000 W500 B14
8228/2		4	2	SPAZZOLA CARBONE V.24 MOTORE	BRUSH CARB. 24 V
8229		2	5	MOTORE R36AT3S 24V CC 550W CAVETTI	MOTOR R36AT3S 24V CC 550 WATT
8257		1	2	PESO SUPPLEMENTARE I. ø 110 L. 110	SUPPLEMENTARY WEIGHT
8260		1	2,4	TUBO DETERGENTE A SERBATOIO	DETERGENT TUBE TO TANK
8263			2	PROFILO GOMMA PROTEZIONE CARTER	PROFILE RUBBER PROTECTION CARTER
8269		2	4	TUBO FLESSIBILE ACQUA SPORCA	FLEXIBLE TUBE
8270		1	4	TAPPO FEMMINA SPORCA 1"	DRAIN PLUG FOR DIRTY WATER
8277		6	5	DISTANZIALE ASPIRATORI ALLUMINIO ø 10	10 X 71,5 VACUUM DISTANCE TUBE
8278		1	5	CURVA ø 40 PE COD. 921238	BEND DIAMETER 40
8279		1	5	RACCORDO T ø 40 PE COD.922209	TEE DIAMETER 40
8280		1	5	PROTEZIONE MOBILE TELERUTTORE LB	MOBILE PROTECTION REMOTE CONTROL SWITCH LB
8281		1	5	CONVOGLIATORE ARIA SX	LEFT AIR CONVEYOR
8282		1	5	CONVOGLIATORE ARIA DX	RIGHT AIR CONVEYOR
8283		1	5	SUPPORTO ASPIRATORE MOBILE LB - LBT	SUPPORT COMPLETE EXHAUST FAN
8284		1	5	SUPPORTO TELERUTTORE FISSO LB - LBT	FIXED SUPPORT REMOTE CONTROL SWITCH LB - LBT
8289		1	3	MOUSSE ADESIVA MM 5 SPESSORE 2	MOUSSE
8361		1	7	PROFILO TERGI CURVO L. 510	510 CURVED PROFILE WIPER
8362		1	7	PROFILO TERGI CURVO L. 610	610 CURVED PROFILE WIPER
8363		1	7	PROFILO TERGI CURVO L. 710	710 CURVED PROFILE WIPER



COD.	NOTE	Q. TA'	TAV. N°	DESCRIZIONE	DESCRIPTION
					
8365	510	1	2	SPAZZOLA NERA 0,25 M. 510 RAS. ø 100	0,25 510 BLACK BRUSH
8366	510	1	2	SPAZZOLA NERA 0,40 M. 510	F.0.40 510 HARD BLACK BRUSH
8369	610	1	2	SPAZZOLA NERA 0,25 M. 610 RAS. ø 100	0,25 610 BLACK BRUSH
8370	610	1	2	SPAZZOLA NERA 0,40 M. 610	F.0.40 610 HARD BLACK BRUSH
8373	710	1	2	SPAZZOLA NERA 0,25 M. 710 RAS. ø 100	0,25 710 BLACK BRUSH
8374	710	1	2	SPAZZOLA NERA 0,40 M. 710	F.0.40 710 HARD BLACK BRUSH
8380		1	2,3	FIANCATA TRASMISSIONE LB	LB DRIVE SIDE
8382		1	2	FIANCATINA DX SPORGENTE	PROJECTIONG RIGHT SIDE
8383		2	2	ALBERO OTTONE CH. ESAGONALE 17 TRASMISSIONE SPAZZOLE	TREE BRASS - CH. HEXAGONAL 17 TRANSMISSION
8384		1	3	INGRANAGGIO ELICOIDALE DX PER ALBERO CH. 17	RIGHT HELICAL GEAR FOR SHAFT
8385		1	3	INGRANAGGIO ELICOIDALE SX PER ALBERO CH. 17	LEFT HELICAL GEAR FOR SHAFT
8386		2	2	PERNO INOX CH. ESAGONALE 17 SUPPORTO SPAZZOLA	HINGE INOX CH. HEXAGONAL 17 SUPPORT BRUSHES
8519		1	3	INGRANAGGIO CAMPANA LB - LC	BELL GEAR - V. 24 MOTOR
8521		2	3	INGRANAGGIO ø 99 SX C - C	COMPLETE ø 99 GEAR
8522		1	3	INGRANAGGIO DI RINVIO C - C	COMPLETE TRANSMISSION GEAR
8525		3	3	INGRANAGGIO INTERNO CAMPANA	COMPLETE INTERNAL BELL GEAR

MAT. N°

SERIAL N°

DATA

DATE